

CRITICAL CARE TOWER – 4th Floor, Intensive Care



FOURTH FLOOR - ICU - ARCHITECTURAL PLAN

3/20/17

CRITICAL CARE TOWER – 5th Floor, Step Down

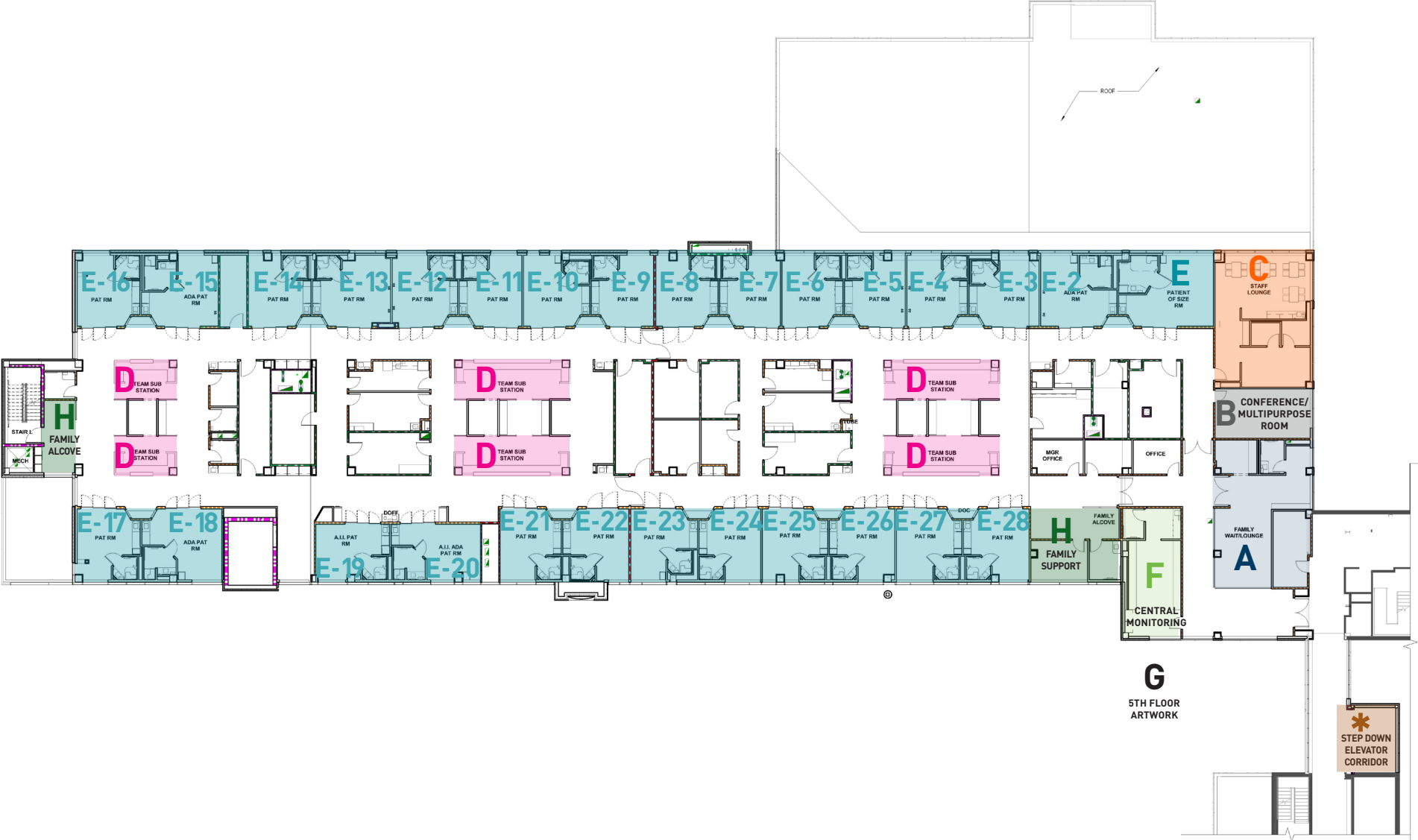

FIFTH FLOOR - STEP DOWN - ARCHITECTURAL PLAN

3/22/11 1:07

CRITICAL CARE TOWER – 6th Floor, Future Nursing

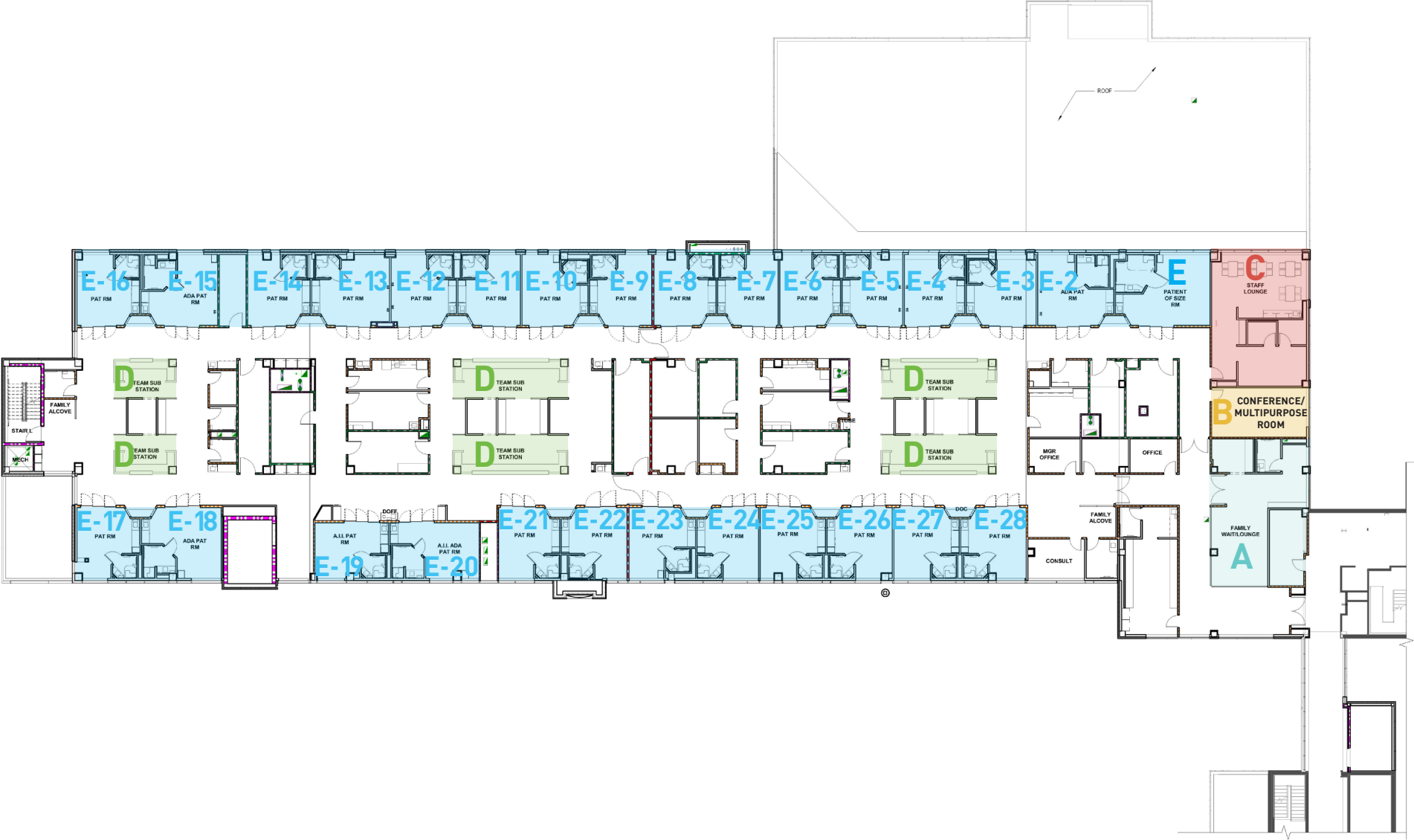

FIFTH FLOOR - STEP DOWN - ARCHITECTURAL PLAN

3/22/11 1:07